

AMS28

SECTORS:



CHARACTERISTICS:

- Balanced.
- System attached to the shaft by allen screws.
- Not dependent on the rotation direction.
- External mounting.

OPERATING LIMITS:

$d_1 = 25$ to 175 mm $p = 15$ kg/cm²

$v = 2$ m/s $t = -20$ to $+200^\circ\text{C}$ (*)

(*) The temperature resistance depends on the material of the secondary seals used.

The operating limits are defined by the PV factor which is determined for the sealing system characteristics and those of the application.

DESCRIPTION:

It can be used in vertical agitators with moderate speeds without the need to apply auxiliary lubrication systems. Adapted to DEBRIS cleaning systems.

COMPONENTS:

- 1 Rotating contact surface
- 2 Stationary contact surface
- 3 O-rings
- 3a O-rings
- 4 Springs
- 5 Metal frame
- 5a Set screws

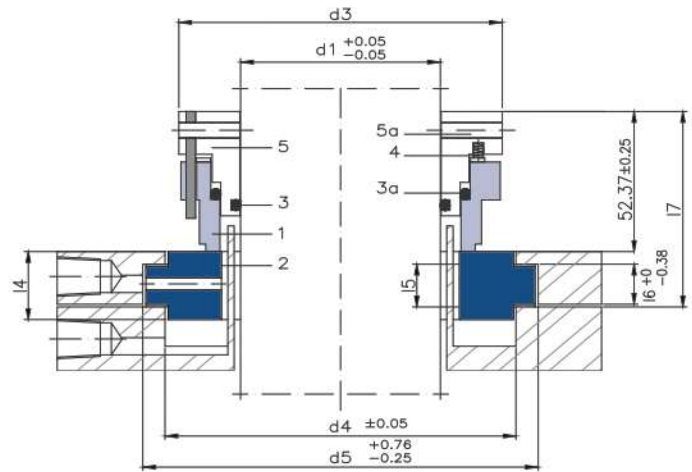

DIMENSIONS CHART Dimensions in mm

Shaft mm	Rotary part		Stationary part				
	d_3	d_4	d_5	l_4	l_5	l_6	l_7
25	635	47.6	57.9	20.6	12.7	11.9	69.0
28	66.6	50.8	61.1	20.6	12.7	11.9	69.0
30	69.8	53.9	67.5	22.2	12.7	11.9	69.0
32	69.8	53.9	67.5	22.2	12.7	11.9	69.0
33	73.0	57.1	70.6	22.2	12.7	11.9	69.0
35	73.0	57.1	70.6	22.2	12.7	11.9	69.0
38	76.2	63.5	77.0	22.2	12.7	11.9	69.0
40	79.3	66.6	80.2	22.2	12.7	11.9	69.0
43	82.5	69.8	83.3	22.2	12.7	11.9	69.0
45	85.7	73.0	89.7	25.4	15.9	15.1	73.0
50	88.9	79.3	96.0	25.4	15.9	15.1	73.0
53	92.0	79.3	99.2	25.4	15.9	15.1	73.0
55	95.2	85.7	102.4	25.4	15.9	15.1	73.0
58	98.4	88.9	105.6	25.4	15.9	15.1	73.0
60	98.4	88.9	105.6	25.4	15.9	15.1	73.0
63	101.6	92.0	108.7	25.4	15.9	15.1	73.0
65	104.7	95.2	111.9	25.4	15.9	15.1	73.0
68	107.9	98.4	115.1	25.4	15.9	15.1	73.0
70	107.9	98.4	115.1	25.4	15.9	15.1	73.0
75	114.3	103.3	119.8	25.4	15.9	15.1	73.0
80	120.6	111.1	127.8	25.4	15.9	15.1	73.0
85	123.9	114.3	131.1	25.4	15.9	15.1	73.0
90	130.2	120.7	137.3	25.4	15.9	15.1	73.0
95	133.3	123.8	140.5	25.4	15.9	15.1	73.0
100	139.7	133.3	150.0	25.4	15.9	15.1	73.0
105	142.9	136.5	153.2	25.4	15.9	15.1	73.0
110	149.2	142.8	159.5	25.4	15.9	15.1	73.0
115	155.5	149.2	165.9	25.4	15.9	15.1	73.0

DIMENSIONS CHART For Imperial Shaft Sizes

Shaft (")	Rotary part		Stationary part					
	mm	d_3	d_4	d_5	l_4	l_5	l_6	l_7
1.00	25.40	63.50	47.63	57.94	20.62	12.70	11.89	69.04
1.13	28.58	66.68	50.80	61.11	20.62	12.70	11.89	69.04
1.25	31.75	69.85	53.98	67.46	20.62	12.70	11.89	69.85
1.38	34.93	73.03	57.15	70.64	20.62	12.70	11.89	69.85
1.50	38.10	76.20	63.50	76.99	20.62	12.70	11.89	69.85
1.63	41.28	79.38	66.68	80.16	20.62	12.70	11.89	69.85
1.75	44.45	82.55	69.85	83.34	20.62	12.70	11.89	73.03
1.88	47.63	85.73	73.03	89.69	25.40	15.88	11.89	73.03
2.00	50.80	88.90	79.38	98.32	25.40	15.88	11.89	73.03
2.13	53.98	92.08	79.38	99.21	25.40	15.88	15.06	73.03
2.25	57.15	95.25	85.73	102.39	25.40	15.88	15.06	73.03
2.38	60.33	98.43	88.90	105.56	25.40	15.88	15.06	73.03
2.50	63.50	101.60	92.08	108.74	25.40	15.88	15.06	73.03
2.63	66.68	104.78	95.25	111.91	25.40	15.88	15.06	73.03
2.75	69.85	107.95	98.43	115.09	25.40	15.88	15.06	73.03
2.88	73.03	111.13	101.60	118.26	25.40	15.88	15.06	73.03
3.00	76.20	114.30	104.78	119.84	25.40	15.88	15.06	73.03
3.13	79.38	117.48	107.95	124.61	25.40	15.88	15.06	73.03
3.25	82.55	120.65	111.13	127.79	25.40	15.88	15.06	73.03
3.38	85.73	123.83	114.30	130.96	25.40	15.88	15.06	73.03
3.50	88.90	127.00	117.48	134.14	25.40	15.88	15.06	73.03
3.63	92.08	130.18	120.65	137.31	25.40	15.88	15.06	73.03
3.75	95.25	133.35	123.83	140.49	25.40	15.88	15.06	73.03
3.88	98.43	136.53	127.00	143.66	25.40	15.88	15.06	73.03
4.00	101.60	139.70	130.18	150.01	25.40	15.88	15.06	73.03
4.13	104.78	142.88	133.35	153.19	25.40	15.88	15.06	73.03
4.25	107.95	146.05	136.53	156.36	25.40	15.88	15.06	73.03
4.38	111.13	149.23	139.70	159.54	25.40	15.88	15.06	73.03
4.50	114.30	152.40	142.88	162.71	25.40	15.88	15.06	73.03

Dimensions subject to changes or modifications.